

ASPIRANTE
by TRITON

***Aspirante Topaz
thermostatic control
electric shower***



Installation and Operating Instructions

Installers please note these instructions are to be left with the user

CONTENTS	Page
Important safety information	1
Introduction	2
Specifications	2
Understanding your Topaz	2
Key to main components	3
Electrical requirements	4 - 5
Water requirements	6
Siting of the shower	6 - 7
Fitting the shower to the wall	7 - 8
Plumbing connections	8 - 9
Electrical connections	9
Commissioning	10
Fitting the trim plate	11
Replacing the cover	11
Operating the shower	12 - 13
Operating functions	13 - 14
Changing the fascia	14
Adjusting and cleaning the sprayhead	15
Cleaning the inlet filter	16
Cleaning the scale trap	16
Fault finding	17 - 18
Preparations	19
Guarantee, service policy, etc.	rear cover

To ensure the product suitability for commercial and multiple installations, please contact Triton's specification advisory service prior to installation.

Telephone: (024) 7632 5491

Facsimile: (024) 7632 4564

E mail: technical@tritonplc.co.uk

PLEASE READ THIS IMPORTANT SAFETY INFORMATION

- ◆ Products manufactured by Triton are safe and without risk provided they are installed, used and maintained in good working order in accordance with our instructions and recommendations.
- ◆ DO NOT operate shower if frozen, or suspected of being frozen. It must thaw out before using.
- ◆ DO NOT operate the unit if the sprayhead or spray hose becomes damaged.
- ◆ DO NOT restrict flow out of shower by placing sprayhead in direct contact with your body.
- ◆ DO NOT operate the shower if water ceases to flow during use or if water has entered inside the unit because of an incorrectly fitted cover.

1 GENERAL

1.1 Isolate the electrical and water supplies before removing the cover.

1.2 Read all of these instructions and retain them for later use.

1.3 DO NOT take risks with plumbing or electrical equipment.

1.4 Isolate electrical and water supplies BEFORE proceeding with the installation.

1.5 The unit must be mounted onto the finished wall surface (on top of the tiles). DO NOT tile top to unit after fixing to wall.

1.6 Contact Customer Service (see back page), if any of the following occur:

- a) If it is intended to operate the shower at pressures above the maximum allowed the minimum stated.
- b) If the unit shows a distinct change in performance.
- c) If the shower is frozen.

1.7 If it is intended to operate the shower in areas of hard water (above 200ppm temporary hardness), a scale inhibitor may have to be fitted. For advice on the Triton Scale Inhibitor, contact Triton Customer Service.

1.8 The sprayhead must be cleaned regularly with descaler to remove scale and debris, otherwise restrictions to the flow on the outlet of the unit will result in higher temperatures and could also cause the Pressure Relief Device in the unit to operate.

1.9 This product is not suitable for mounting into steam rooms or steam cycles.

2 PLUMBING

2.1 The plumbing installation must comply with Water Regulations, Building Regulations or any particular regulations as specified by Local Water Company or Water Undertakers and should be in accordance with BS 6700.

2.2 The supply pipes must be flushed to clear debris before connecting to the shower unit.

2.3 DO NOT solder pipes or fittings within 300mm

of the shower appliance, as heat transfer can damage components.

2.4 DO NOT fit any form of outlet flow control as the outlet acts as a vent for the heater can.

2.5 DO NOT use excessive force when making connections to the flexible hose or sprayhead, finger tightness is sufficient.

2.6 All plumbing connections MUST be completed BEFORE making the electrical connections.

3 ELECTRICAL

3.1 The installation must comply with BS 7671 'Requirements for electrical installations' (IEE wiring regulations) or any particular regulations as specified by the local Electrical Supply Company.

3.2 This appliance MUST be earthed.

3.3 In accordance with 'The Plugs and Sockets etc. (Safety) Regulations 1994', this appliance is intended to be permanently connected to the fixed wiring of the electrical mains system.

3.4 Ensure all electrical connections are tight to prevent overheating.

3.5 Fuses do not give personal protection against electric shock.

3.6 To enhance electrical safety a 30mA residual current device (RCD) should be installed in all UK electric and ungrounded shower circuits. This may be part of the consumer unit or a separate unit.

3.7 Switch off immediately at isolating switch if water ceases to flow during use.

3.8 Other electrical equipment i.e. extractor fans, pumps must not be connected to the circuits within the unit.

3.9 Switch off at isolating switch when not in use. This is a safety procedure recommended with all electrical appliances.

3.10 As with all electrical appliances it is recommended to have the shower and installation checked at least every two years by a competent electrician to ensure there is no deterioration due to age and usage.

INTRODUCTION

This book contains all the necessary installation and operating instructions for your Aspirante Topaz thermostatic electric shower.

Take time to read this book thoroughly and familiarise yourself with all instructions BEFORE commencing installation. Please keep it for future reference.

The shower installation must be carried out by a suitably qualified person and in the sequence of this instruction book.

Care taken during the installation will ensure a long, trouble-free life from your shower.

SPECIFICATIONS

Electrical

Nominal power rating at 240V	Nominal power rating at 230V
9.5kW – (40A MCB rating)	8.7kW – (40A MCB rating)
10.5kW – (45A MCB rating)	9.6kW – (45A MCB rating)

Water

Inlet connection – 15mm diameter.
 Outlet connection – 1/2" BSP male thread.

Entry Points

Water and cable – top bottom only.

Materials

Backplate, cover, controls, sprayhead – ABS.
 Sprayplate – Acetal.
 Elements – Minerally insulated corrosion resistant metal sheathing.

Dimensions

Height - 335mm
 Width - 225mm
 Depth - 95mm

Standards and Approvals

Waterproof rating IPX4.
 Complies with the requirements of current British and European safety standards for household and similar electrical appliances.
 Complies with requirements of the British Electrotechnical Approvals Board (BEAB).
 Meets with Compliance with European Community Directives (CE).

UNDERSTANDING YOUR TOPAZ

Temperature/flow rate

The temperature control on the unit can be adjusted to provide shower temperatures nominally between 35°C and 47°C. The unit will give higher and lower temperatures if given extreme supply conditions.

Note: The maximum flow rate for the given temperature will be greater in summer than in winter because of ambient temperature variance of the mains water supply.

It is strongly advised to select economy power during periods of hot weather, otherwise at all other times, leave the power setting at full to provide the maximum flow rate.

Safety cut-out

The unit is fitted with a non-resettable over-temperature safety device. In the event of abnormal operation which could cause unsafe temperatures within the unit, the device will disconnect the heating elements. It will require a visit from a qualified engineer to determine the nature of the fault and replace the safety device, once the unit has been repaired.

Replacement parts can be ordered from Customer Service. See 'spare parts' for details and part numbers. Due to continuous improvement and updating, specification may be altered without prior notice.

Important: When first installed the unit will be empty. It is essential the unit should contain water *before* the elements are switched on. As this unit has electronic control, it is vital that the commissioning procedure is followed. Failure to carry out this operation will result in damage to the unit and will invalidate the guarantee.

KEY TO MAIN COMPONENTS

Inside unit

- 1 Top cable / pipe entry
- 2 Bottom cable / pipe entry
- 3 Wall screw fixings
- 4 Power Printed Circuit Board
- 5 Thermal cut-out
- 6 Can and element assembly
- 7 Ribbon cable connector
- 8 Ceramic terminal lock
- 9 Earth connection
- 10 PRD
- 11 Solenoid valve
- 12 Trip plate
- 13 Thermostatic valve
- 14 Scale trap
- 15 Pressure switch
- 16 Shower outlet
- 17 Guide sockets

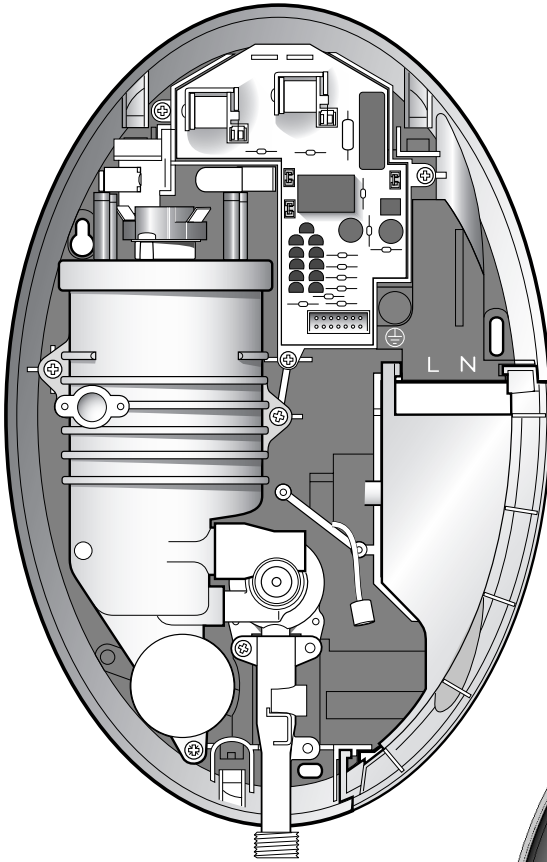

Inside cover

- 18 Control Printed Circuit Board
- 19 Start/stop Printed Circuit Board
- 20 Cover tags
- 21 Ribbon cable

Pack contents

- Shower unit
- Four position sprayhead
- Screw fixing kit
- Instructions, guarantee, etc.

Riser rail kit ordered separately.

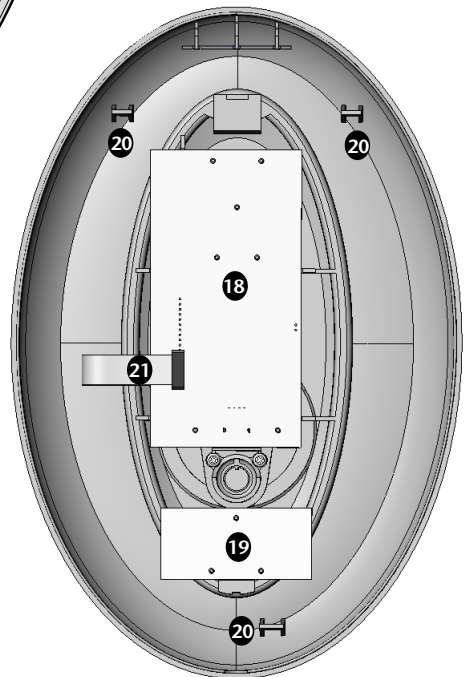

ELECTRICAL REQUIREMENTS

WARNING!
THIS APPLIANCE MUST BE EARTHED

IMPORTANT: The installation, supply cable and circuit protection must conform with IEE wiring regulations and be sufficient for the amperage required.

The following notes are for guidance only:

1 The shower must only be connected to a 230-240V ac supply. If you are installing a shower with a kilowatt rating above 9kW, it is advisable to contact the local electricity supply company.

1.1 The electrical rating of the shower is shown on the rating label (see below) within the unit.

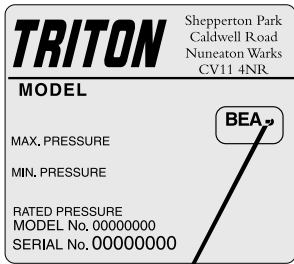

2 Before making any sort of electrical connection within the installation, ensure that no terminal is live. If in any doubt, switch off the whole installation at the consumer unit.

3 The shower must be connected to its own independent electrical circuit. IT MUST NOT be connected to a ring main, pur, socket outlet, lighting circuit or cooker circuit.

3.1 The electrical supply must be adequate for the loading of the unit and existing circuits.

4 Check your consumer unit (main fuse box) has a main switch rating of 80A or above and that it has a spare fuse way which will take the fuse or miniature circuit breaker (MCB) necessary for the shower (see schematic of installation circuit opposite).

4.1 If your consumer unit has a rating below 80A or if there is no spare fuse way, then the installation will not be straightforward and may require a new consumer unit serving the house or just the shower.

4.2 You will need to contact the local electricity company. They will check the circuit and carry out what is necessary. They will also check the main bonding.

5 The earth continuity conductor of the electrical installation must be effectively connected electrically to all exposed metal parts of other appliances and services in the room in which the shower is to be installed, to conform to current IEE regulations.

5.1 All exposed metal parts in the bathroom must be bonded together using a cable of at least 4mm² cross sectional area. These parts include metal baths, radiators, water pipes, taps and waste fittings.

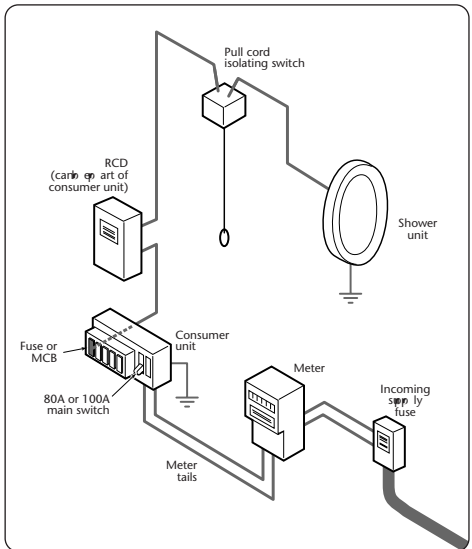

6 For close circuit protection DO NOT use a wire in the fuse. Instead use a suitably rated MCB or cartridge fuse (see table below).

CIRCUIT PROTECTION		
unit rating	MCB	cartridge fuse
7.0kW	30/32A	30A
7.5kW	32A	35A
8.0kW	40A	35A
8.5kW	40A	45A
9.0kW	40A	45A
9.5kW	40/45A	45A
10.5kW	45A	45A

6.1 In the interest of electrical safety a 30mA residual current device (RCD) should be installed in all UK electric and ungrounded shower circuits. This may be part of the consumer unit or a separate unit.

7 A 45 amp double pole isolating switch with a minimum contact gap of 3mm in both poles must be incorporated in the circuit.

7.1 It must have a mechanical indicator showing when the switch is in the OFF position, and the wiring must be connected to the switch without the use of a plug or socket outlet.

7.2 The switch must be accessible and clearly identifiable but out of reach of a person using a fixed bath or shower, except for the cord of a cord operated switch, and should be placed so that it is not possible to touch the switch body while standing in a bath or shower cubicle. It should be readily accessible to switch off after using the shower.

8 Where shower cubicles are located in any rooms other than bathrooms, all socket outlets in those rooms must be protected by a 30mA RCD.

9 To obtain full advantage of the power provided by the shower, use the shortest cable route possible from the consumer unit to the shower.

9.1 The current carrying capacity of the cable must be at least that of the shower circuit protection (see table below).

Twin and earth PVC insulated cable CURRENT CARRYING CAPACITY		
installed in an insulated wall	in conduit or trunking	clipped direct or buried in a non insulated wall
6mm ²	6mm ²	6mm ²
32A	38A	46A
10mm ²	10mm ²	10mm ²
43A	52A	63A
16mm ²	16mm ²	16mm ²
57A	69A	85A

Note: Cable selection is dependent on derating factors

9.2 It is also necessary to satisfy the disconnection time and thermal constraints which mean that for any given combination of current demand, voltage drop and cable size, there is a maximum permissible circuit length.

10 The shower circuit should be separated from other circuits by at least twice the diameter of the cable or conduit.

10.1 The current rating will be reduced if the cabling is bunched with others, surrounded by thermal loft or wall insulation or placed in areas where the ambient temperature is above 30°C. Under these conditions, derating factors apply and it is necessary to select a larger cable size.

10.2 In the majority of installations, the cable will unavoidably be placed in one or more of the above conditions. Therefore, it is strongly recommended to use a minimum of 10mm cabling throughout the shower installation.

10.3 It is essential that individual site conditions are assessed by a competent electrician to determine correct cable size and permissible circuit length.

WATER REQUIREMENTS

The installation must be in accordance with Water Regulations/Byelaws.

To ensure activation of the heating elements, the shower must be connected to a mains water supply with a minimum running pressure of 100kPa (1.0 bar) at a minimum flow rate of nine litres per minute with a maximum static pressure of 1000kPa (10 bar).

Note: For the 10.5kW rated shower, the minimum running pressure must be 150kPa (1.5 bar) at a minimum flow rate of eleven litres per minute with a maximum static pressure of 1000kPa (10 bar). If the stated flow rates are not available, it may not be possible to achieve optimum performance from the unit throughout the year.

Under site conditions where the shower supply is below 220 volts and the mains water pressure is below 5 bar, it is recommended to fit a pressure reducing valve set at 3.5 bar.

A typical system layout is shown below.

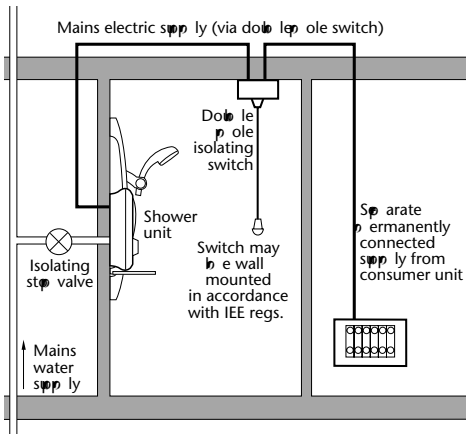

During periods of high ambient temperatures it may be necessary to select a lower power setting to achieve your preferred shower temperature. The water supply can be taken from a cold water storage cistern provided there is a minimum head of ten metres above the sprayhead (fifteen metres for the 10.5kW rated shower). It must be an independent supply to the shower only.

If you intend to operate the shower at pressures above the maximum or below the minimum stated, contact Customer Service.

DO NOT use jointing compounds on any pipe fittings for the installation.

SITING OF THE SHOWER

WARNING!

The shower must not be positioned where it will be subjected to freezing conditions.

IMPORTANT: For ease of servicing, the unit must always be mounted on the surface of tiled walls. NEVER tile up to the unit.

Refer to the illustration below for correct siting of the shower.

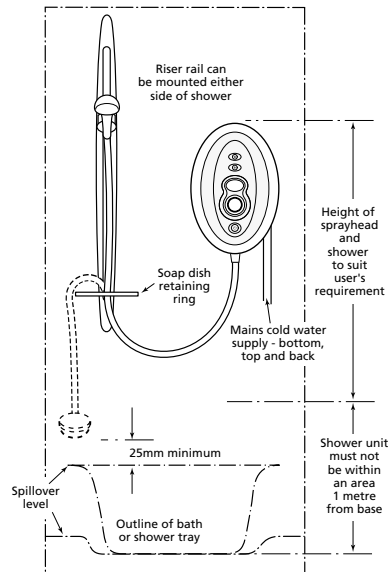

Position the unit where it will NOT be in direct contact with water from the sprayhead. Position the shower unit vertically.

Allow sufficient room between the ceiling and the shower to access the cover top screws.

IMPORTANT: The unit must be mounted on a flat surface which covers the full width and length of the backplate, otherwise difficulty

may arise when fitting the cover and subsequent operation of the unit may be impaired.

Note: Water regulations require the sprayhead to be 'constrained by a fixed or sliding attachment so that it can only discharge water at a point not less than 25mm above the spill-over level of the relevant bath, shower tray or other fixed appliance'. The use of the supplied soap dish will in most cases meet this requirement, but if the sprayhead cannot be placed within the bath basin or shower tray, then a double check valve, or similar, must be fitted in the supply pipe network to prevent back-flow.

Liquid Crystal Display

This shower unit has a LCD which has an optimum viewing angle that is slightly below eye level. The unit should be positioned so the display is at nose level, but for multiple users of varying heights, an optimum shower height must be arrived at.

Pressure relief safety device

A pressure relief device (PRD) is designed into the shower unit which complies with European standards. The PRD provides a level of protection should an excessive build up of pressure occur within the shower.

DO NOT operate the shower with a damaged or kinked shower hose, or a locked sprayhead which can cause the PRD to operate.

Make sure the PRD outlet at the bottom of the unit is not locked.

When commissioning, the sprayhead must be removed from the flexible hose. Failure to follow this procedure may cause the PRD to operate.

Make sure the shower is positioned over the bath or shower tray because if the PRD operates, then water will eject from the bottom of the unit.

Should this happen, turn off the electricity and water supplies to the shower at the isolating switch and stop valve. Contact Customer Service for advice on replacing the PRD.

FITTING THE SHOWER TO THE WALL

Note: The control knob is an integral part of the cover – DO NOT attempt to remove it.

Lift the cover from the appliance. To facilitate the pipe and cable connections, remove the trim plate by just lifting away from the appliance.

Entry positions for the mains water are from the top bottom or back. Cable entry is via the top, bottom or back.

Note: Deviations from the designated entry points will invalidate product approvals.

If bottom surface entry is required, then the necessary hole will need to be cut out in the 'thinned section' of the trim plate using a junior hacksaw and file.

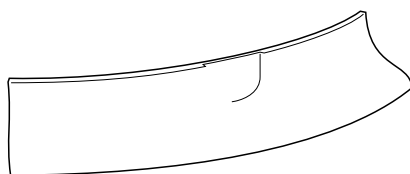

If bottom or rear entry is chosen, the trim plate will need to be fitted in the top entry position on the appliance (as shown). The trim plate is packaged separately.

IMPORTANT: If planning to use a silicon seal around the backplate edge, do not place sealant in the area of the PRD exit channel.

connectors as full engagement cannot be guaranteed. DO NOT use excessive force when making these connections.

IMPORTANT: Before connecting the water supply to the inlet of the shower, and in compliance with Water Regulations, flush out the pipework to remove all swarf and system debris. This can be achieved by connecting a hose to the pipework and turning on the mains water supply long enough to clear the debris to waste. Make sure the backplate is square on the wall and tighten the three retaining screws holding it to the wall. Check the backplate is not distorted when screws are fully tightened.

Turn on the mains water supply and check for leaks in the pipework connection to the shower.

Note: At this stage no water can flow through the unit.

ELECTRICAL CONNECTIONS

A schematic wiring diagram is shown below.

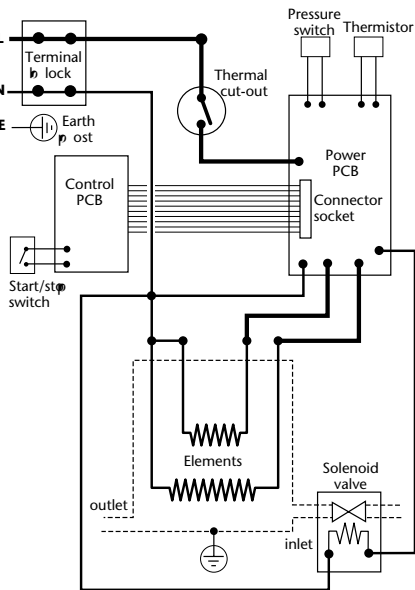

The cable entry points are top bottom only. The cable can be surface clipped, hidden or via 20mm conduit.

Note: Conduit entry can only be from rear.

SWITCH OFF THE ELECTRICITY SUPPLY AT THE MAINS.

Route the cable into the shower unit and connect to the terminal block as follows:

Earth cable to terminal marked **E**

Neutral cable to terminal marked **N**

Live cable to terminal marked **L**

IMPORTANT: Fully tighten the terminal block screws and make sure that no cable insulation is trapped under the screws. Loose connections can result in cable overheating.

Note: The supply cable earth conductor must be sleeved. The outer sheath of the supply cable must be stripped back to the minimum.

The supply cable must be secured either by routing through conduit or in trunking or by embedding in the wall, in accordance with current IEE regulations.

The use of connections within the unit to supply power to other equipment i.e. extractor fans, pumps etc. will invalidate the guarantee.

DO NOT switch on the electricity supply until the cover has been fitted.

Note: The elements on UK models are to 240V specification and will give a lower kW rating if the voltage supply is below 240V.

COMMISSIONING

The first operation of the shower is intended to flush out any remaining system debris and to purge the unit to ensure the heater unit contains water before the elements are switched on.

Refit the trip latch carefully guiding into the locating slots in the cap plate.

At this stage, the cover is temporarily fitted in order to carry out the commissioning procedure.

A) Offer the cover to the unit. DO NOT connect the 14-way ribbon cable at this stage.

B) Make sure the valve spindle has the 'flat' and keyway slot foremost (12 o'clock position).

C) Make sure the temperature control knob on the cover has 'ASPIRANTE' horizontal with the blue/red graphics at the top (the knob 'flat' inside the cover should be foremost).

D) Carefully locate the cover tags into the guide sockets on the cap plate and ensure wires are not trapped.

E) Guide into position so that the control spindle locates correctly (the 'flats' ensure the spindle and knob only fit one way). Should any difficulty arise, recheck the points above.

While applying slight pressure to the front cover, secure in position with the three retaining screws supplied. Fit the flexible hose (put without the sprayhead) to the shower outlet with the outlet of the hose directed to waste.

Make sure the supplied sealing washer is in place.

Turn on the water supply to the shower at the isolating stop valve. Switch on the electricity supply to the shower at the isolating switch. Water will commence to flow through the unit and discharge from the flexible hose.

Note: Rotating the temperature control during commissioning will not increase the flow rate through the shower unit.

It will take about thirty seconds for a smooth flow of water to be obtained while air and any debris being dispersed from the shower.

When you have a smooth flow of water, disconnect the electricity supply to the shower at the isolating switch. This will stop the water flow.

Unscrew the cover retaining screws again and lift the cover from the cap plate.

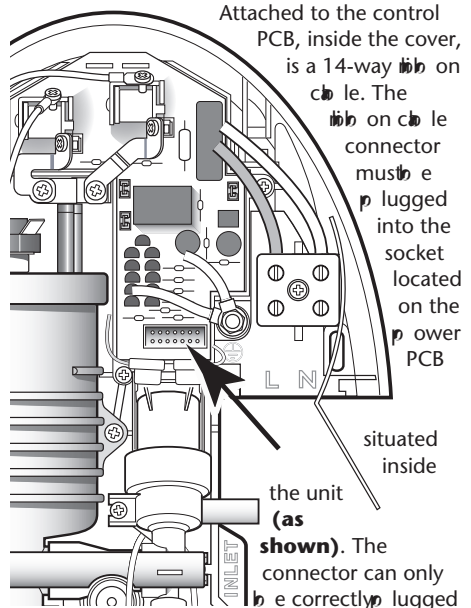
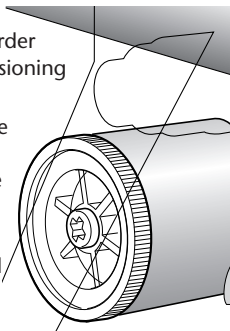

The connector can only be correctly plugged in one way by virtue of a location lug on the plug. The ribbon cable also has a coloured edge which is on the right-hand side when correctly fitted to the socket.

FITTING THE TRIMPLATE

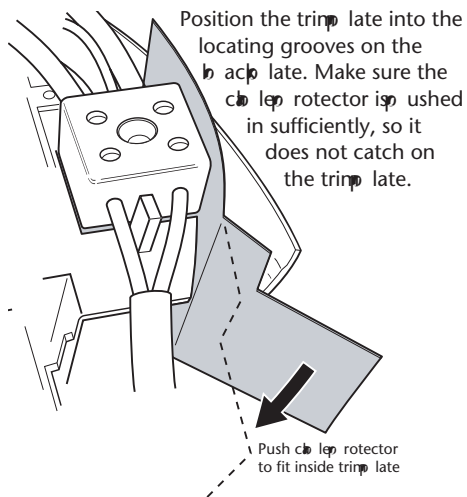

Offer the cover to the unit. Carefully locate the cover tags into the guide sockets on the backplate, and make sure that any wires are not trapped. Guide into position so that the control spindle locates correctly (the 'flats' ensure the spindle and knob will only fit one way). While applying slight pressure to the front cover, secure into position with the three retaining screws.

The flexible hose can be left attached to the shower outlet. With the supplied sealing washer in place, attach the sprayhead to the hose.

Once the riser rail kit is installed, the shower is ready for normal operation.

REPLACING THE COVER

WARNING!

If using a silicon seal around the backplate edge, ensure the PRD exit behind the outlet pipe is kept clear.

Important: Before finally fitting the cover, the following steps must be taken:

- a) Check all plumbing connections are water tight.
- b) Check terminal block screws are fully tightened.
- c) Make sure pipe and cable entering the unit do not prevent the cover locating correctly to the backplate.
- d) Check the valve spindle has the 'flat' and keyway slot uppermost (12 o'clock position).
- e) Make sure the temperature control knob on the cover has 'ASPIRANTE' horizontal with the blue/red graphics at the top (the knob 'flat' inside the cover should be uppermost).

OPERATING THE SHOWER

IMPORTANT: The shower head must be removed from the shower head holder before the shower can be used.

After the shower head is removed, the shower can be used. The shower head is removed by pulling it down from the shower head holder. The shower head is then held in the shower head holder. The shower head is then held in the shower head holder.

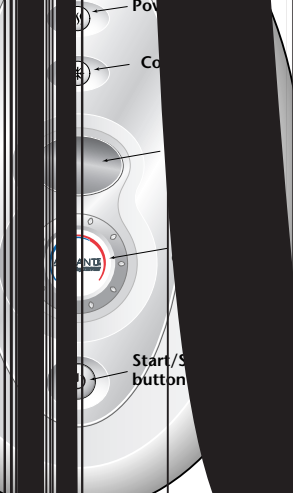

Press the power button to turn the shower on. The shower will start with a 30-second delay. The start button will then commence the shower. The dip switch shows a 30-second delay for three seconds.

The dip switch then shows a 30-second delay for three seconds. The dip switch then shows a 30-second delay for three seconds. The dip switch then shows a 30-second delay for three seconds.

- The dip switch then shows a 30-second delay for three seconds.
- The dip switch then shows a 30-second delay for three seconds.
- The dip switch then shows a 30-second delay for three seconds.

Start the shower

Press the start/stop button to start the shower.

ry to achieve the same
 before. Note however, that if the
 h at full power, then it will not be
 tain the same temperature on
 er. The shower will endeavour to
 hest temperature at the best flow

ted flow rate required for the
 met due to low water pressure, it
 y to operate the shower on
 t during hot months because of
 ons enter the shower.

er is on the full position. The
 and the shower will be set to
 e. The shower will be set to
 e. The shower will be set to
 ing this
 ow rate
 s to achieve the
 same temperature as



efore or to correspond to the current
 temperature control position.

It is advised to leave the shower setting at full at
 all times, except during periods of hot weather.

To adjust the shower temperature

The showering temperature is varied by turning
 the temperature control which changes the mix
 of hot water coming from the heater can and
 the incoming cold water. On the dial lay
 circumference are eleven outer segments which
 represent the total angular movement of the
 temperature control. Rotating the temperature
 control causes inner segments to move, thus
 indicating the actual position of the control
 relative to its minimum and maximum limits.

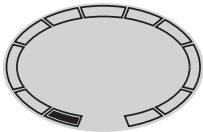

Minimum temperature
 position (one inner
 segment full that
 corresponds to the
 control position).



Maximum temperature
 position (all inner
 segments filled that
 corresponds to the
 control position).

To decrease the shower temperature

Turn the temperature
 control anti-clockwise;
 the current
 temperature dial is
 replaced by two
 flashing 'down arrows'.

Five seconds later the dial shows the revised
 temperature.

To increase the shower temperature

Turn the temperature control clockwise; the
 current temperature dial is replaced by two
 flashing 'up arrows'. Five seconds later the
 dial shows the revised temperature.

Note: It is advisable to be certain that the
 showering temperature is satisfactory by testing
 with your hand BEFORE stepping under the
 sprayhead.

There will always be a time delay of a few
 seconds between selecting a temperature and
 the water reaching the shower selected
 temperature.

OPERATING FUNCTIONS

Clean sprayhead

After a reset number of start/stop button
 operations, the start routine acts as normal
 but instead of a blue 'OK'
 the dial backlight turns
 red and a flashing 'CS'
 alternating with a flashing
 sprayhead symbol and
 'CLEAN' appear.

This is a reminder to clean the sprayhead. It
 does NOT indicate a defect to the shower.

To remove the red 'CS' from the dial, press
 the power and cold buttons simultaneously for
 three seconds. Alternatively, you can choose not
 to remove the flashing indication and carry on
 by pressing the stop button and showering
 as normal. The sprayhead symbol and 'CLEAN' will
 continue to appear on the side of the °C figure for
 a number of operations after which time

Low pressure



When the display backlight turns red and 'LP' and 'LOW PRESSURE' flash alternately, it means the water pressure has fallen below the minimum required for

correct operation of the shower. This causes the low pressure switch to operate and this turns off power to the heating elements preventing any maintained temperature rises. Water will no longer flow until the unit has been reset.

Press the 'START/STOP' button once to reset the shower. The shower will shut down and then begin its start up routine.

If there is still insufficient pressure for correct operation the 'LOW PRESSURE' display will flash once more and the shower will require resetting again.

If there is sufficient pressure the display will change to show 'OK' in the usual backlight and the shower will run as normal.

Phased shutdown

In use, when the start/stop button is pressed, power is switched off to the elements and the power indicator will extinguish. The display changes to a flashing 'SD' and water continues to flow for a few seconds, flushing out any remaining hot water. This ensures the next immediate user will not receive a slug of hot water if standing under the sprayhead when starting the shower.

Safety cut-out

The shower is fitted with a thermal cut-out safety device. In the event of abnormal operation which could cause unsafe temperatures within the unit, the device will disconnect the heating elements.

It will require a visit from a qualified engineer to determine the nature of the fault and replace the safety device, once the unit has been repaired.

CHANGING THE FASCIA

This shower unit has the facility for the coloured fascia to be simply changed for another colour of your choice. The coloured options are available as low cost accessories and are listed in the 'spare parts' section at the rear of this booklet. To change the fascia proceed as follows:

The top of the fascia has a recessed cutaway. With your finger, just press down in the cutaway and pull away. To replace the fascia position the lower end into the recess of the cover and push fit the top into position.

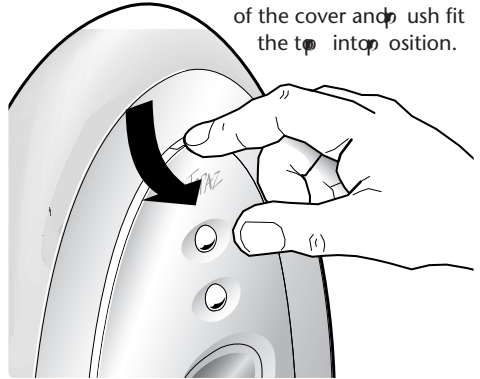

WARNING!

After any servicing of mains water supply, always make sure the unit is started on COLD in order to purge any air in the pipework.

Note: In normal use, it is normal to leave the water supply permanently on to the shower unit, but as with most electrical appliances, **the unit should be switched off at the isolating switch when not in use.**

ADJUSTING THE SPRAYHEAD

Four sprayhead patterns are available. Adjustment is only by turning the bezel on the sprayhead in either direction until the desired pattern is obtained.



MAXI
A full spray effect for a relaxing shower.

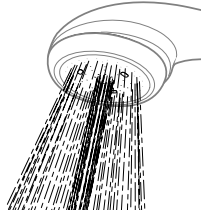

ULTRA
A focused spray for a refreshing, satisfying shower.

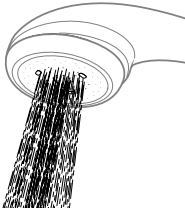

NEEDLE
A tingling, fine spray for a highly invigorating shower.

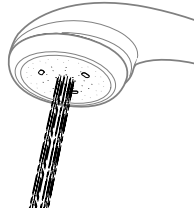

JET
A concentrated spray for an exhilarating shower.

CLEANING

IMPORTANT: Do not use abrasive or solvent cleaning fluids. The shower unit, riser rail, hose, etc. should be cleaned using a soft cloth and warm water.

Before cleaning, turn the unit off at the isolation switch to avoid the shower being accidentally switched on.

IT IS IMPORTANT TO KEEP THE SPRAYHEAD CLEAN TO MAINTAIN THE PERFORMANCE OF THE SHOWER.

The hardness of the water will determine the frequency of cleaning. For example, if the

shower is used every day in a very hard water area, it may be necessary to clean the sprayhead on a weekly basis.

Sprayplate removal

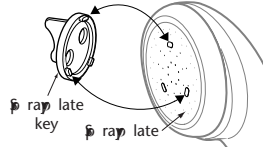

There is no need to remove the sprayhead from the hose.

Using the removal tool supplied (as shown), locate the three raised 'bosses' into the

three recesses in the sprayplate.

Hold it firmly and twist anti-clockwise.

This movement may turn the cartridge assembly as well until it reaches a 'stop'.

Hold the cartridge firmly and continue to twist anti-clockwise.

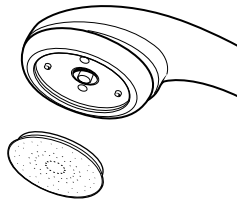
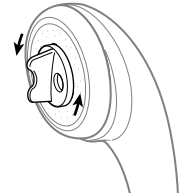

Having loosened the sprayplate sufficiently, it can be unscrewed and removed completely.

Clean the sprayplate with a suitable brush or preferably leave it

to soak overnight in a mild proprietary descaler. Make sure all traces of scale are removed and thoroughly rinse in clean water afterwards.

Before replacing the sprayplate, switch the shower back on at the isolating switch and direct the hose and sprayhead to waste.

Press the start/stop button followed by the 'COLD' button.

This operation will flush out any loose scale deposits in the unit and sprayhead. Stop after about thirty seconds.

Refit the sprayplate by screwing clockwise. Use the tool to screw the sprayplate tight.

INSTRUCTIONS FOR INSTALLERS AND SERVICE ENGINEERS ONLY

Cleaning the inlet filter

It is recommended that the filter is periodically cleaned in order to maintain the performance of the shower. *It is essential that this operation is carried out by a competent person.*

SWITCH OFF THE ELECTRICITY SUPPLY AT THE MAINS.

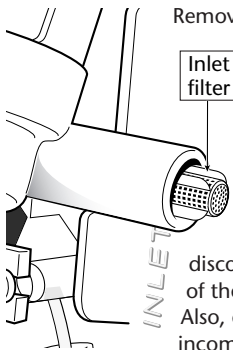

Remove the cover. The inlet filter is situated in the solenoid inlet (as shown) and can be removed to clean.

To gain access to the filter requires the trip plate to be removed and disconnection and removal of the compression fitting. Also, depending on the incoming pipework

arrangements, if there is not enough slack in the pipework, it could mean the removal of the unit from the wall.

When cleaning the plastic filter, DO NOT use a sharp object, as it will cause damage. It is preferable to use an old toothbrush or similar.

Cleaning the descalable water heater

It is recommended in hard water areas, the scale trap is periodically cleaned to maintain the performance of the shower. *It is essential that this operation is carried out by a competent person.*

SWITCH OFF THE ELECTRICITY SUPPLY AT THE MAINS.

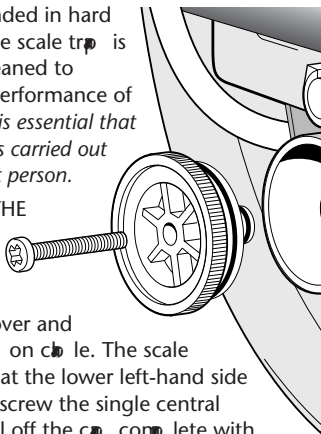

Remove the cover and unplug the knob on cable. The scale trap is located at the lower left-hand side of the unit. Unscrew the single central screw then pull off the cap complete with

'O' rings. Be aware of water discharging as the heater can exhausts. Clean out the trap and remove all sediment. Flush the can throughly leaving the cap off and switching the power at the isolating switch.

Note: Make sure the water that flows out of the scale trap will safely flow to waste.

Switch the power off at the isolating switch. Replace the cap, checking the 'O' rings are in place and free from debris. Secure with the central screw.

Switch the power back on again at the isolating switch to enable the can to fill with water. Check for water leakage at the scale trap. When water flows smoothly from the sprayhead, stop the flow by switching the power off at the isolating switch.

Reconnect the knob on cable and replace the cover and secure with the three screws.

FAULT FINDING

IMPORTANT: Switch OFF the electricity at the mains supply and remove the circuit fuse before removing the cover from the shower while attempting any fault finding inside the unit.

<i>Problem/Symptom</i>	<i>Cause</i>	<i>Action/cure</i>
1 Shower inoperable.	1.1 Interrupted power supply.	1.1.1 Blown fuse or circuit breaker. Check supply. Renew or reset fuse or circuit breaker. If it fails again, consult a qualified electrician. 1.1.2 Power cut? Check other appliances and if necessary, contact local Electricity Co.
	1.2 Unit malfunction.	1.2.1 Have unit checked by suitably qualified electrician or contact Customer Service.
2 Water flows when isolating switch is switched on	2.1 Ribbon cable is not connected.	2.1.1 Switch off the electricity supply, remove the shower cover and plug in ribbon cable.
	2.2 Unit malfunction.	2.2.1 Contact Customer Service.
3 Water too hot.	3.1 Temperature control incorrect setting.	3.1.1 Turn anti-clockwise.
	3.2 Unit malfunction.	3.2.1 Contact Customer Service.
4 Unstable shower temperature or flow.	4.1 Blockages.	4.1.1 Clean sprayhead. Check inlet filter.
	4.2 Loose ribbon cable connection.	4.2.1 Check connections on PCB.
	4.3 Unit malfunction.	4.3.1 Contact Customer Service.
5 Water too cool or cold.	5.1 Temperature control incorrect setting.	5.1.1 Turn clockwise.
	5.2 Unit malfunction.	5.2.1 Contact Customer Service.
	5.3 Safety cut-out operated.	5.3.1 The thermal safety cut-out device has operated. Have unit checked by suitably qualified electrician or contact Customer Service.

FAULT FINDING (continued)

<i>Problem/Symptom</i>	<i>Cause</i>	<i>Action/cure</i>
6 'LP' flashing on display.	6.1 Water pressure has dropped below minimum required.	6.1.1 Wait until water pressure has returned to normal.
	6.2 Blockage in inlet.	6.2.1 Check and clean filter in the inlet.
	6.3 Loose connection on PCB.	6.3.1 Check connection on PCB from pressure switch.
	6.4 Blocked connecting tube to pressure switch.	6.4.1 Ensure the tube from solenoid valve to pressure switch is not kinked or blocked.
7 Water continues to flow when unit is isolated at isolating switch.	7.1 Defect in solenoid.	7.1.1 Contact Customer Service for advice.
8 Pressure relief device has operated (water ejected from PRD tube).	8.1 Blocked sprayhead.	8.1.1 Clean or replace blocked sprayhead cartridge and then fit a new PRD.
	8.2 Twisted flexible shower hose.	8.2.1 Check for free passage through hose. Replace the hose if necessary, then fit new PRD.
	8.3 Sprayhead not removed whilst commissioning.	8.3.1 Fit new PRD. Commission unit with sprayhead removed.

Note: Identify cause of operation before fitting new PRD unit. When fitting a new PRD, follow the commissioning procedure.

It is advised all electrical maintenance/repairs to the shower should be carried out by a suitably qualified person.

SPARE PARTS

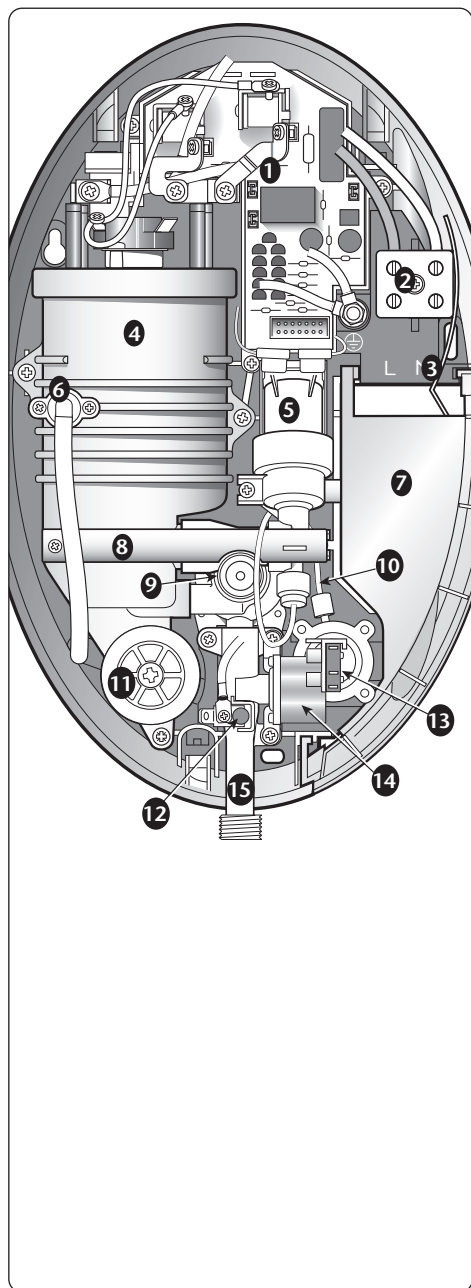

Ref.	Description	Part No.
1	Printed circuit board (PCB)	7073234
2	Ceramic terminal block & wires	S07720905
	Ceramic terminal block	22010930
3	Clock rotator	7103271
4	Heater can assembly 9.5kW c/w restrictor & TCO	83307090
4	Heater can assembly 10.5kW c/w restrictor & TCO	83307100
-	Restrictor 9.5kW	22010310
-	Restrictor 10.5kW	22010410
5	Solenoid valve assembly and 'O' ring	83307110
6	Pressure Relief Device (PRD)	82800450
7	Trip plate	7053138
8	Carburetor	7053008
9	Thermostatic valve and 'O' rings (4)	83307130
10	Connecting tube	22010260
11	Scale trap cover c/w 'O' rings and screw	83307140
12	Dip layer thermistor	22010300
13	Pressure switch microswitch & wires	P07710904
14	Pressure switch and 'O' ring	83307120
15	Outlet pipe assembly	S07711000
-	Cover assembly c/w control PCB, start/stop PCB, knobs & buttons	S07720605
-	Wire set 2 x earth & 1 x solenoid wires	83307150
-	Roller microswitch cover	7063046
-	Inlet filter	7053009

16 4 mode p rayhead (all chrome) 22420120

17 Coloured fascias

Seap ray
Aqua
Azure
Lilac
Midnight
Chrome
Satin chrome
Gold

TSTZFSEA
TSTZFAQU
TSTZFAZU
TSTZFLIL
TSTZFMID
TSTZFCHR
AETZFSAT
AETZFGLD

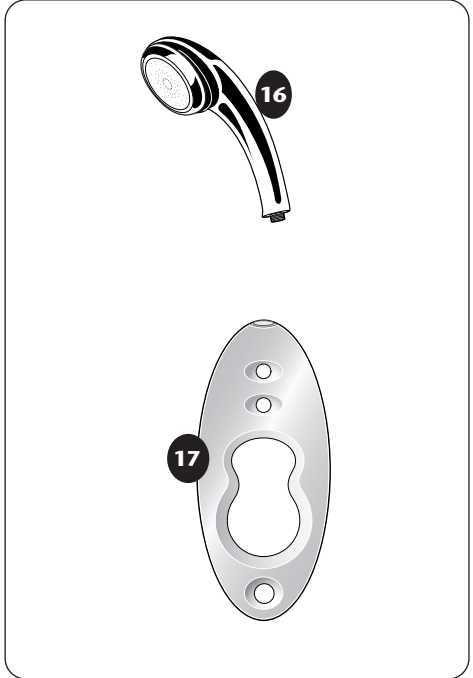



A **MORGROS** Company

Service Policy

In the event of a complaint occurring, the following procedure should be followed:

1 Telephone Customer Service on (024) 7637 2222 (08457 626591 in Scotland and in Northern Ireland), having available the model number and power rating of the product, together with the date of purchase.

2 Triton Customer Service will be able to confirm whether the fault can be rectified by either the provision of a replacement part or a s58 -6t from the Triton Service Engineer.