

Cleaning:

- > Clean the outside of this heater only with a soft dry cloth
- > Do not use any chemical or abrasive cleaners.

Maintenance:

- > There are no user serviceable parts inside. Refer servicing or repair to a qualified, competent person.

Eventually, you may want to replace this heater:

When your heater comes to the end of its life or you choose to update or upgrade it by replacing it, please do not dispose of it with your normal household waste or by depositing in a local amenity tip. When you buy your replacement heater, take this unit to your retailer for them to take back for recycling. New regulations will oblige retailers and some recycling centres to take in Waste from Electrical and Electronic Equipment (European "WEEE Directive").



If you experience problems:

If your heater is defective or develops a fault, please return it to the place where you bought it. You can call our Helpline for advice. The Helpline will gladly give advice on any aspect of any Eterna product but may not be able to give specific instructions regarding individual installations.

If in doubt, consult a qualified electrician.

Help line:

Tel: 01933 673 144 Fax: 01933 678 083 Email: sales@eterna-lighting.co.uk



IMPORTANT!

Safety and Installation instructions

3kW Screen Heater

Model(s)
SH3WH

Features:

- 3 heat settings
- Protection against overheating
- Suitable for wall and ceiling installation
- Adjustable angle

**PLEASE READ THESE INSTRUCTIONS BEFORE
INSTALLING YOUR NEW FITTING**

PLEASE RETAIN FOR FUTURE REFERENCE

Read this first:

- > **If in any doubt, consult a qualified electrician.**
- > Suitable for indoor use only.
- > Suitable for fixing on a normally flammable surface.
- > When choosing the location for your new fitting, ensure that the fixings will be anchored in a solid surface e.g. concrete, brick or a joist—do not fix directly onto panelling, cladding, plasterboard etc.
- > Before making fixing hole(s), check that there are no obstructions hidden beneath the mounting surface such as pipes or cables.
- > If the location of your new fitting requires the provision of a new electrical supply, the supply must conform with the requirements of the latest edition of the IEE wiring regulations.
- > Do not cover.
- > Switch off the mains before commencing installation and remove the appropriate circuit fuse.
- > Make connections to the electrical supply in accordance with the following code:
 - Live - Brown or Red
 - Neutral - Blue or Black
 - Earth - Green and Yellow
- > If you are connecting to the mains using a fused spur, a 13 Amp fuse should be fitted.
- > This product must be connected to Earth.
- > Ensure that the heater cannot blow hot air directly onto any flammable surface or any surface which may be damaged or discoloured by heat.
- > **If in any doubt, consult a qualified electrician.**

Installation:

1. Remove the three screws from the front panel and remove it—see diagram [2].
2. Loosen, but do not remove the retaining bolt using a spanner as shown in diagram [3] and remove the bracket—see diagram [6].
3. Make fixing holes in wall or ceiling using the wall bracket as a template and secure bracket using the fixings supplied. If the fixings supplied are not suitable for your installation, use appropriate alternative fixings—see diagram [4]. **Note:** the bracket must be fixed to a solid point e.g. brick, concrete, stud or joist.
4. Hang the heater on the bracket, ensure that the bracket is located between the bolt and the serrated washer and that the bolts are at the end of the slots in the bracket, see diagram [3].
5. Adjust the heater to the required angle and tighten the bolts using a spanner. Take care not to over-tighten.
6. Re-fit the front panel.
7. Connect mains cable (fitted) to the power supply according to the wiring code above.
8. Restore the power and switch on.

Safety markings:

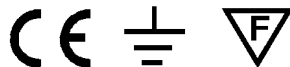

Operation:

- The large switch is a master switch, turning this switch on and off will start and stop the fan and heaters if selected.
- The degree of heat is controlled by switches I & II—see diagram [5].

Master switch only—cold fan.

Master + switch I or II—Warm air (1500W).

Master + switches I & II—Hot air (3000W).

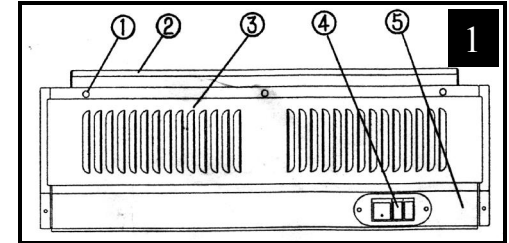

Components:

- | | |
|-----|--------------|
| (1) | Screw |
| (2) | Wall Bracket |
| (3) | Front panel |
| (4) | Switches |
| (5) | Body |

Safety overheating protection:

- If the unit overheats, thermal switches will cut the power and will restore the power when the unit has cooled down. However, if the unit overheats severely, thermal fuses will isolate the cut the power: these fuses will not reset and cannot be replaced by the user. The unit should be referred to a qualified, competent person for repair

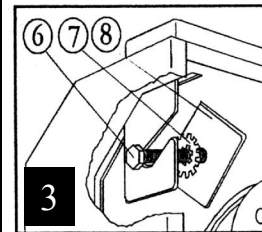
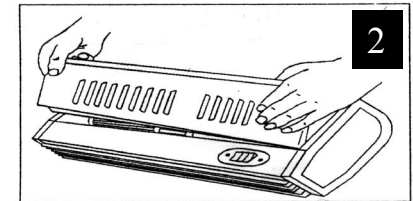

- | | |
|-----|-----------------|
| (6) | Retaining bolt |
| (7) | Serrated washer |
| (8) | Mounting point |

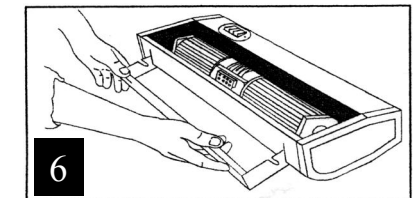
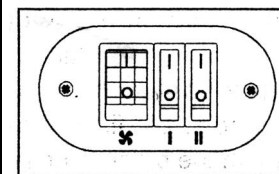
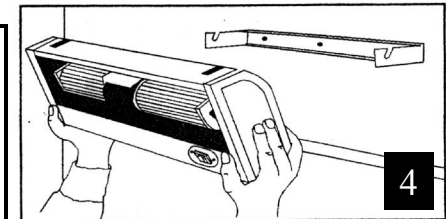

Ceiling installation

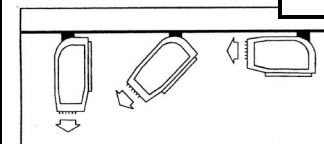

Wall installation

